

ILLUSTRATED PARTS LIST

STARTER KIT

Model Number

MA 804

Effective Date

July 1, 1969

Form Number

14821P1

APRIL 17 1971 STARTER 78.39
 " 23 1971 MUFFLER 747
 FAN BELT 85.86

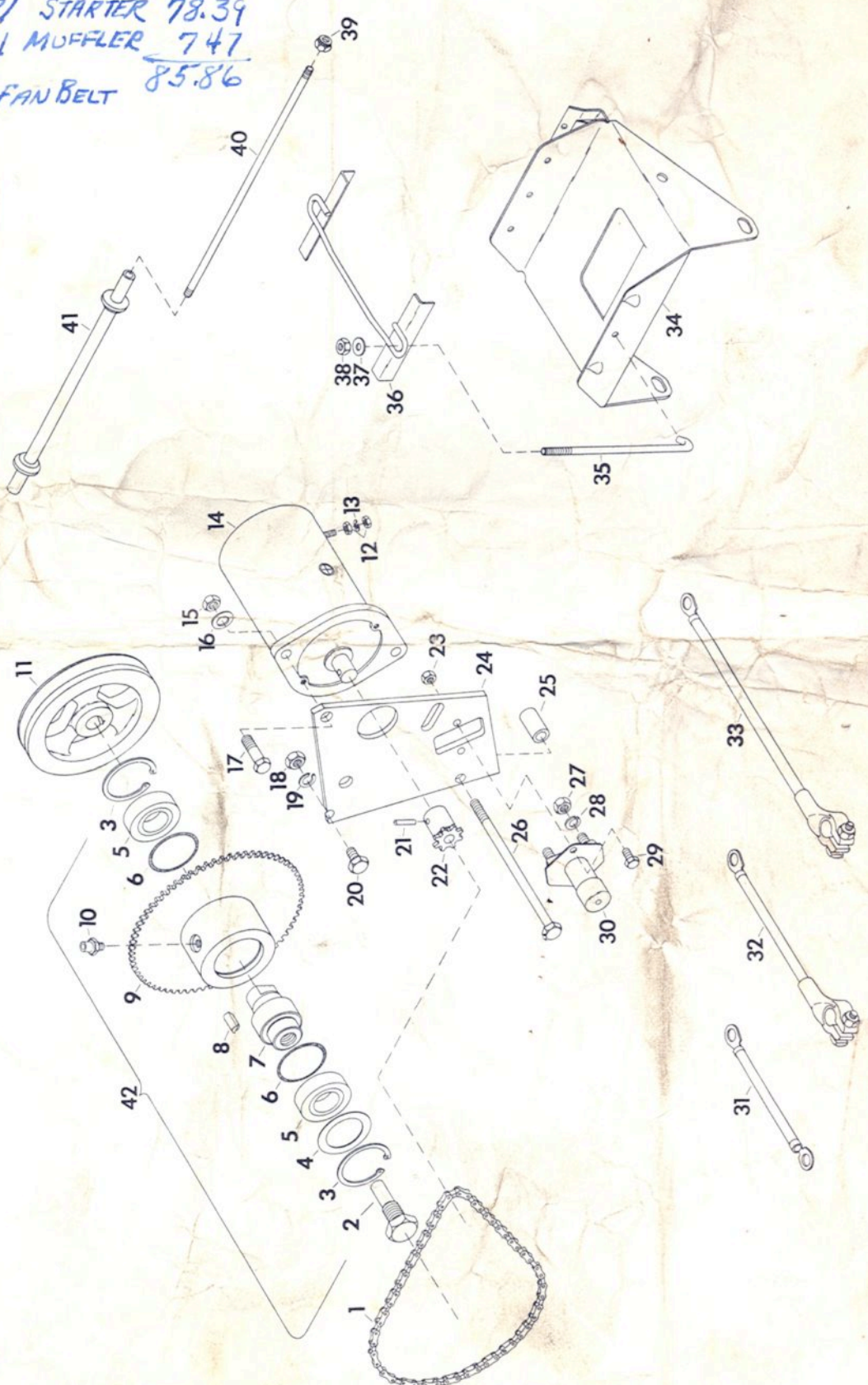

<u>ITEM NO.</u>	<u>PART NO.</u>	<u>DESCRIPTION</u>
1	13483P1	Sprocket Chain
2	12111P1	Special Starter Bolt
3	13581P1	Retaining Ring
4	13324P1	Shim
5	12493P1	Ball Bearing
6	12900P1	Clutch Spring
7	12112P1	Drive Nut
8	12899P1	Cam Roller
9	10198A1	Sprocket Weldment
10	12902P1	Starter Clutch Plug
11	13333P1	Fan Drive Pulley
12	114501	1/4 Hex. Jam Nut
13	103319	1/4 Lock Washer
14	12896P1	Starting Motor
15	120377	3/8 Hex. Nut
16	120394	13/32 Flatwasher
17	180124	3/8 x 1 1/4 Hex. Hd. Bolt
18	120376	5/16 Hex. Nut
19	120214	5/16 Lockwasher
20	180077	5/16 x 3/4 Hex. Hd. Bolt
21	456652	Spring Pin
22	12891P1	Sprocket
23	120315	1/4 Hex. Nut
24	12892P1	Mount Plate
25	12905P1	Spacer
26	127802	5/16 x 7 Hex. Hd. Bolt
27	114502	5/16 Hex. Jam Nut
28	103320	5/16 Lockwasher
29	180018	1/4 x 5/8 Hex. Hd. Bolt
30	13484P1	Starter Foot Switch
31	12897P1	Switch To Starter Cable
32	6980P1	Ground Cable
33	12895P1	Battery To Switch Cable
34	8261A2	Battery Bracket Assembly
35	12894P1	Battery Hold Down Bolt
36	10633P1	Battery Hold Down
37	120392	9/32 Flat Washer
38	120375	1/4 Hex. Nut
39	454750	1/4 Locknut
40	8252P1	Pivot Rod
41	8251A1	Pivot Tube Weldment
42	10183P1	Starter Clutch Assembly